

Tubular Handles

Tube Aluminum / Stainless Steel

SPECIFICATION

Handle tube \varnothing 30 x 1.5
 Aluminum / Stainless Steel
 Handle legs / Covers
 Plastic (Polyamide PA)

- Glass fiber reinforced
- Temperature resistant up to 100 °C

Tube aluminum
 Powder coated
 Black, RAL 9005, textured finish **SW**
 Handle legs / Covers, black, matte finish

Tube aluminum
 Anodized, natural color **EL**
 Handle legs / Covers, black, matte finish

Tube aluminum
 Anodized, natural color **ELG**
 Handle legs / Covers, light gray, matte finish

Tube Stainless Steel AISI 304
 ground, matte shiny finish **NG**
 Handle legs / Covers, black, matte finish



TECHNICAL INFORMATION

- Load rating information (see page A35)
- Stainless Steel characteristics (see page A26)
- Plastic characteristics (see page A2)

INFORMATION

Owing to their large range of variants and their classic design GN 666 (see page) tubular handles are the perfect choice for many applications.

With the modular structure, **special lengths** are available even in comparatively small unit quantities. Large handle lengths can be supported by additional handle legs.

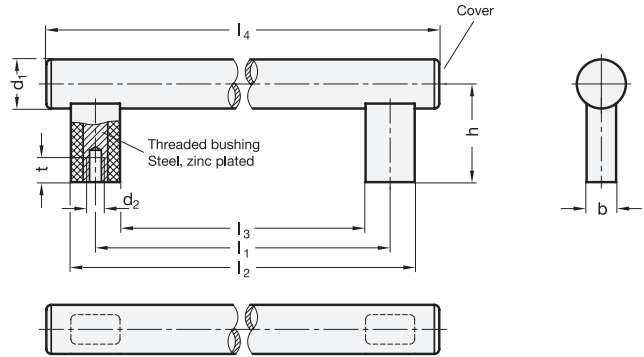

* Complete with Finish of the Tubular handles (SW, WS, EL, ELG or NG)

SW	EL	ELG	NG
black	anodized, black	anodized, light grey	Stainless Steel, black

GN 666

Description	d1	d2	l1 ±0.5	b	h	l2	l3	l4	t min.	⚖
GN 666-30-M6-200-*	30	M 6	200	18	60	230	170	265	12	213
GN 666-30-M6-250-*	30	M 6	250	18	60	280	220	315	12	219
GN 666-30-M6-300-*	30	M 6	300	18	60	330	270	365	12	225
GN 666-30-M6-350-*	30	M 6	350	18	60	380	320	415	12	231
GN 666-30-M6-400-*	30	M 6	400	18	60	430	370	465	12	237
GN 666-30-M6-500-*	30	M 6	500	18	60	530	470	565	12	249
GN 666-30-M6-600-*	30	M 6	600	18	60	630	570	665	12	261
GN 666-30-M8-200-*	30	M 8	200	18	60	230	170	265	15	205
GN 666-30-M8-250-*	30	M 8	250	18	60	280	220	315	15	211
GN 666-30-M8-300-*	30	M 8	300	18	60	330	270	365	15	217
GN 666-30-M8-350-*	30	M 8	350	18	60	380	320	415	15	223
GN 666-30-M8-400-*	30	M 8	400	18	60	430	370	465	15	229
GN 666-30-M8-500-*	30	M 8	500	18	60	530	470	565	15	241
GN 666-30-M8-600-*	30	M 8	600	18	60	630	570	665	15	253

Weight type SW